



## 2019 Conference Package 會議套餐

<p><b>Full Day</b></p> <p>全日會議</p> <p>每位 <b>HK\$580</b> per person (9:00am to 5:00pm)</p>	<p><b>Full Day</b> (without lunch)</p> <p>全日會議 不包括午餐</p> <p>每位 <b>HK\$450</b> per person (9:00am to 5:00pm)</p>	<p><b>Half Day</b></p> <p>半日會議</p> <p>每位 <b>HK\$510</b> per person (9:00am to 1:00pm) (1:00pm to 5:00pm)</p>	<p><b>Half Day</b> (without lunch)</p> <p>半日會議 不包括午餐</p> <p>每位 <b>HK\$380</b> per person (9:00am to 1:00pm) (1:00pm to 5:00pm)</p>
---	---	--	--

Validity: From January 1 to December 31, 2019 (inclusive)

有效日期: 由 2019 年 1 月 1 日至 2019 年 12 月 31 日止

### Includes:

- Unlimited serving of coffee and tea throughout the meeting
- 2 refreshment breaks for full day conference (**1 refreshment break for half day conference**)
- Business lunch
- Supplement at HK\$100 per person for Holiday Brunch Buffet (Saturday, Sunday & Public Holidays)
- Complimentary valet parking space (subject to availability)
- Use of 1 set of LCD projector with screen (subject to availability)

### Standard meeting equipment includes:

- Flipchart & whiteboard with markers
- Standard PA system with microphones
- LCD Television, DVD, VCD and CD player
- Conference amenities including writing pads, pencils, mints and water

### Remarks:

- Prices are in Hong Kong dollars and subject to 10% service charge
- For minimum 6 persons
- Terms & conditions may apply

### 包括以下優惠:

- 會議期間無限量供應咖啡及茶
- 全日會議提供 2 次茶點 (半日會議提供 1 次茶點)
- 商務午餐
- 每位另加港幣\$100 享用假日自助早午餐 (星期六、星期日及公眾假期)
- 免費享用代客泊車服務 (視乎車位供應情況)
- 免費使用 1 部液晶投影機及屏幕 (視乎供應情況)

### 基本會議設施包括:

- 書寫白板
- 音響設施
- 液晶電視機及影碟播放機
- 文儀及會議設施

### 備註:

- 以上價目以港幣計算，另收加一服務費
- 最少 6 位起
- 附帶條款及細則

### Reservations/ Enquiries 預約或查詢:

☎: (852) 2126 1972    ☎: (852) 3900 3972    ✉: catering@hp8dcatering.com





**Garden Room, 2<sup>nd</sup> Floor** (Maximum 10 tables / 120 persons)

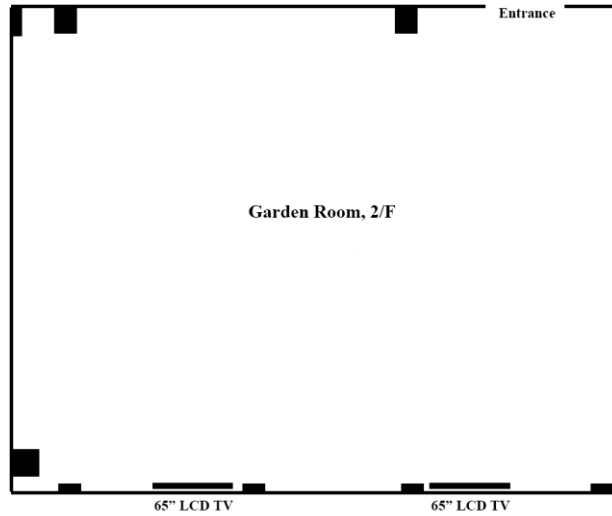

**Salon, 1<sup>st</sup> Floor** (Maximum 25 tables / 300 persons)

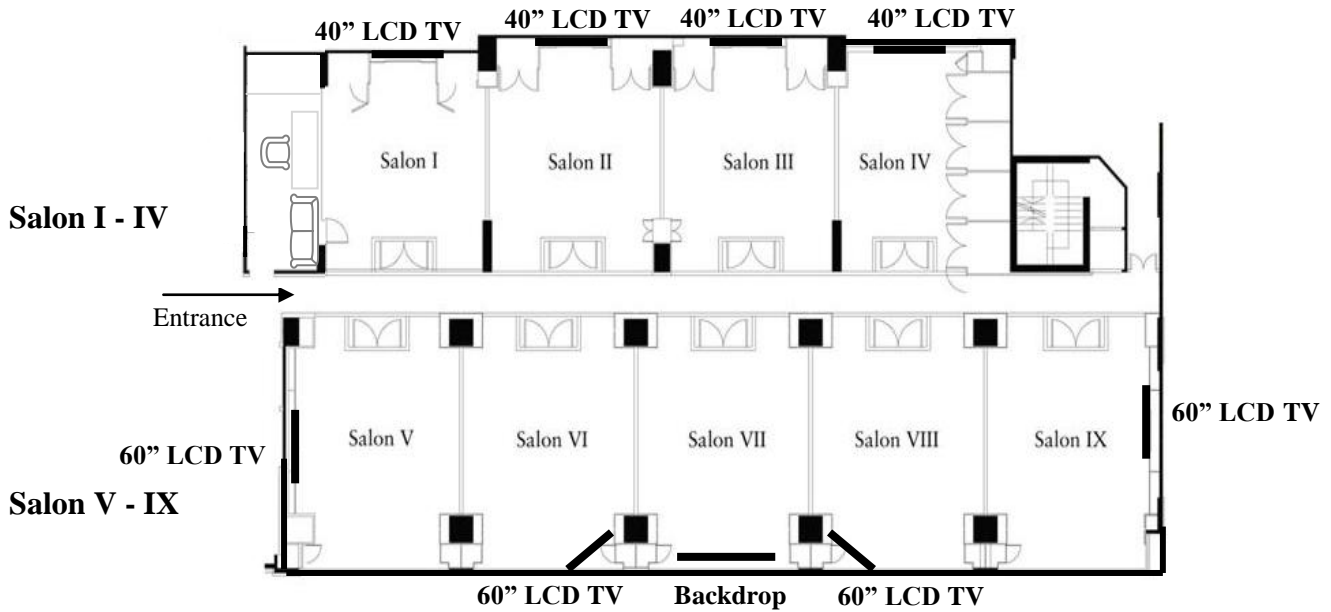

	Size		Height		Banquet persons	Reception persons	Buffet persons	Theatre persons	Classroom persons	U-shape persons	Boardroom persons
	Sq. ft.	Sq. m.	Feet	Metre							
<b>Salon I - IX</b>	4692	439	11.2	3.4	300	350	216	450	174	-	-
<b>Salon I - IV</b>	1833	172	11.2	3.4	120	100	72	192	87	32	36
<b>Salon V - IX</b>	2859	267	11.2	3.4	180	150	120	256	123	32	36
<b>Salon I</b>	426	40	11.2	3.4	24	20	-	27	15	12	18
<b>Salon II</b>	512	48	11.2	3.4	36	30	-	36	18	18	18
<b>Salon III</b>	512	48	11.2	3.4	36	30	-	36	18	18	18
<b>Salon IV</b>	383	36	11.2	3.4	24	20	-	24	15	15	18
<b>Salon V</b>	582	54	11.2	3.4	36	35	-	42	21	18	20
<b>Salon VI</b>	577	54	11.2	3.4	36	35	-	42	21	18	20
<b>Salon VII</b>	577	54	11.2	3.4	36	35	-	42	21	18	20
<b>Salon VIII</b>	577	54	11.2	3.4	36	35	-	42	21	18	20
<b>Salon IX</b>	546	51	11.2	3.4	36	30	-	42	21	18	20
<b>Garden Room</b>	1646	153	8.3	2.5	120	150	72	144	70	33	42

Enquiry Tel: **2126 1972**

Email: catering@hp8dcatering.com

Address: 199 Kowloon City Road, Tokwawan, Kowloon

For reference only, actual may vary.